

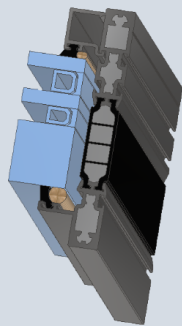

Hansen



Hansen Millennium® EI60

Hansen Millennium® EI60 is fire tested from both external and internal side according to EN 1364-1:2015. The fire test of Hansen Millennium® EI60 covers window elements with different sizes of clear glass and mullion- and transom joints. The construction is only approved with fixed glass. Hansen Millennium® EI60 is based on the Hansen Millennium® system and can therefore be combined with standard windows without visual difference. It makes a big design freedom when designing the facade.

Fire classification:	E60 i<-->o EI60 i<-->o EW60 i<-->o
Design:	Width: 3.576mm at height of 3.000mm Height: 3.600mm at width of 2980mm. The total area of the element can be increased with 20%. It is allowed to put more elements next to each other. It is not allowed to stack up elements.
Profiles:	Hansen Millennium® EI60 profiles. Profiles are prior to machining filled with fire retardant material to increase the fire resistance.
Fire glass:	Contraflam 60-3 (EI60 certified – used for the test) - 27mm Fire protective glass should always be on the inside.
Air permeability:	Class 4
Water tightness:	Class 9A
Wind load classification:	Class C3

TECHNICAL SPECIFICATION

Depth of frame	104,7 mm
Glazing range	53-57 mm
Min/max spacer	6mm/20mm
Glass	<p>Min. thickness of fire protective glass is 27mm, other glass layers should min. be 6mm. Max 2,28mm PVB film (laminated). Requirements/options for other glass layers: toughened/toughened, toughened/laminated, laminated/laminated. With and without coatings. Extra panes can be added if the lamination foil < 1mm. Max width – 1752mm Max height – 3557mm Max area – 5,24m²</p>
Maximum height	H=3600 mm
Maximum width	L=1800mm

Cross section

